

Mattie G. Battles Trust
Volume 982 Page 286

Mulberry Road

Lot No. 27

Lot Line

S. 03° 33' 23" W.

Lot No. 26

2618.99' record
2619.24' observed

Lot No. 27

Lot Line

448.00'

Lot No. 26

3.050 acres

Chester Christian Center Assembly of God, Inc.
Volume 860
Page 767

Lands Remaining in the Name of:
Frank and Joan Durkalski
Volume 715 Page 36

Lands Remaining in the Name of:
Frank and Joan Durkalski
Volume 715 Page 36

Society National Bank, Trustee
Parcel No. 2
Volume 985
Page 182

Curve	Bearing	Chord	Arc	Tan	Radius	Delta
"A"	S 36° 34' 51" W.	122.20'	363.60'	infinite	80.00'	203° 46' 29"
"C"	S 53° 25' 08" E.	51.64'	56.13'	33.81'	40.00'	80° 24' 21"

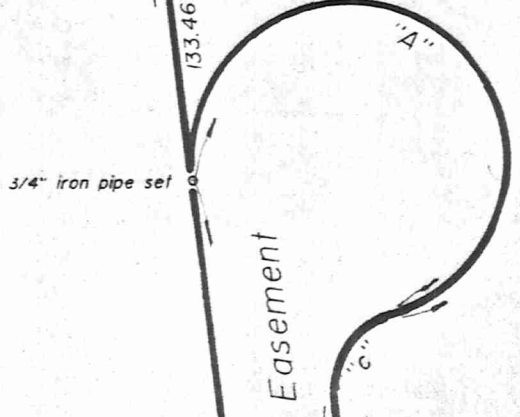

Chillicothe Road Company
Volume 942 Page 162

Lucius Paul and Clara Clark
Volume 958 Page 680

This survey was made at the request of Frank Durkalski and was made in January 1995 of a part of lands of Frank and Joan Durkalski as recorded in volume 715, page 36 of the Geauga County Deed Records and is based only on the information contained in this document. Lawrence Wilson and Associates makes no representation as to the existence of any other record documents that may affect the surveyed property, including but not limited to, title, encumbrances, easements, either aboveground or underground, or restrictions that would be identified by a title report.

No warranty is made concerning the existence, location, condition, type or size of ANY structure, either aboveground or underground. Contact The Ohio Utilities Protection Service at (800)-362-2764 before any and all excavation.

THIS SURVEY IS LIMITED IN SCOPE to locating and describing the 3.050 acre parcel and the Industrial Road Easement and DOES NOT LOCATE THE EXISTING GAS WELL AND UNDERGROUND GAS LINES.

The below certification is valid only to those parties named herein, and is valid only when evidenced by an ORIGINAL SIGNATURE below.

Wilson, Lessman and Cox assumes no liability for the use of unauthorized copies of this plat of survey, nor for any use, or reliance upon, by persons other than those specifically named herein.

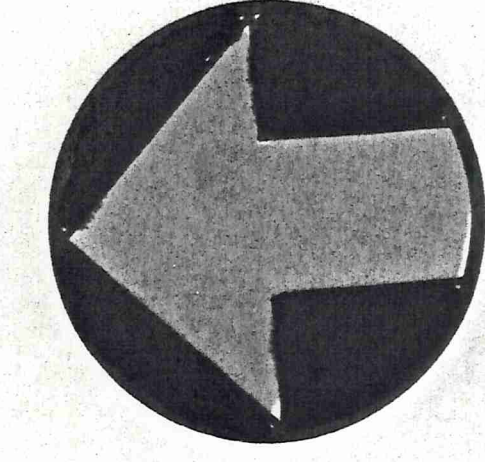

SURVEY PLAT & LEGAL DESCRIPTION
APPROVED PER R.C. 315.251
R.S. 12/19/97
OFFICE OF THE
GEAUGA COUNTY ENGINEER

Frank and Joan Durkalski

I certify that I have prepared this Plat and that it is based on a Survey made by me in accordance with the provisions of Chapter 4733-37 of the Ohio Administrative Code governing land surveys in the State of Ohio.

The bearings shown on this Plat are oriented to an arbitrary meridian and are intended to indicate angular relationships only.

Distances are expressed in U. S. Survey Feet and decimal parts thereof.

Lawrence Gordon Wilson
Professional Surveyor No. 5807
April 18, 1997

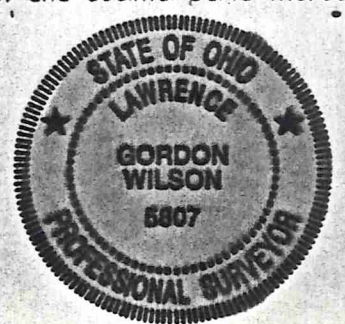

Plat of Survey

of part of lands of

Frank and Joan Durkalski

in

Lot No. 26 in Tract No. 1

Chester Township

Geauga County, Ohio

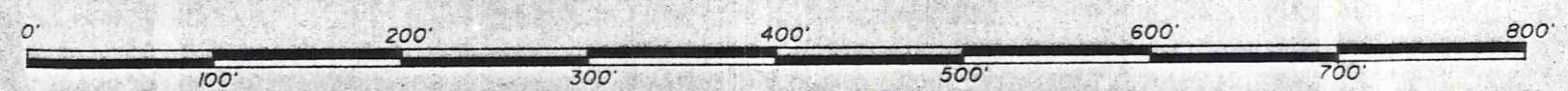

Scale: 1" = 100'

Wilson, Lessman and Cox
Professional Land Surveyors
Village Station
401 South Street
Chardon, Ohio 44024
216-286-7204

CHE 00032
CHE 00032

DURKALSKI
picked up 01-02-98
11-389125

Situated in the Township of Chester, County of Geauga and the State of Ohio, and known as part of Lot No. 26 in Tract No. 1 within said Township, and further described as follows:

Beginning in the northerly line of land conveyed as Parcel No. 2 to Society National Bank, Trustee by deed recorded in volume 985, page 182 of the Geauga County Deed Records at a one inch iron pin found at the southeasterly corner of land conveyed to Chester Christian Center Assembly of God, Inc. by deed recorded in volume 860, page 767 of the aforesaid deed records;

Thence N. 10 deg. 39' 11" W. along the easterly line of said Chester Christian Center Assembly of God, Inc. 460.55 feet to a $\frac{3}{4}$ inch iron pipe set;

Thence S. 86 deg. 26' 54" E. 353.78 feet to a $\frac{3}{4}$ inch iron pipe set in the westerly line of Parcel 2 as conveyed to Mattie G. Battles Trust by deed recorded in volume 982, page 286 of the aforesaid deed records, said westerly line also being the westerly line of Lot No. 27 in said Tract No. 1;

Thence S. 03 deg. 33' 23" W. along said westerly line of Battles and Lot Line 448.00 feet to a one inch iron pipe found at the northeasterly corner of said Parcel No. 2 of said Society National Bank, Trustee;

CHE 00.032

Thence N. 86 deg. 05' 03" W. along said northerly line of Society National Bank, Trustee
240.74 feet to the place of beginning, containing 3.050 acres as surveyed in April 1997 by
Lawrence Wilson, Professional Surveyor No. 5807.

The bearings in this description are oriented to an arbitrary meridian and are intended
to indicate angular relationships only.

SURVEY PLAT & LEGAL DESCRIPTION
APPROVED PER R.C. 315.251

R.W. 12/29/97

OFFICE OF THE
GEAUGA COUNTY ENGINEER

RECEIVED
DEC 29 1997
GEAUGA COUNTY
ENGINEERS